

ENGLISH
ESPAÑOL

TRUPER

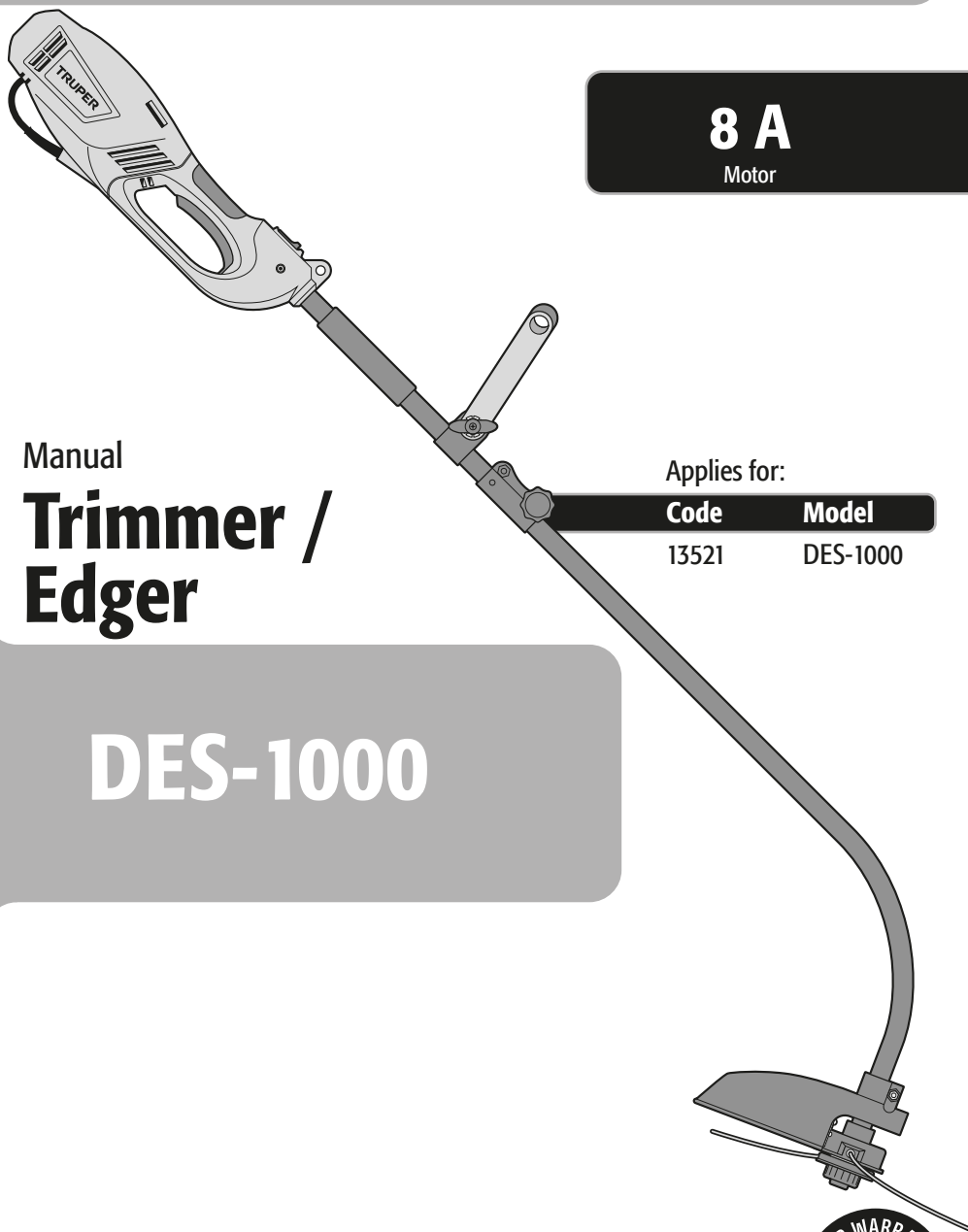

8 A

Motor

Manual

Trimmer / Edger

Applies for:

Code	Model
13521	DES-1000

DES-1000

! CAUTION



Read the user's manual thoroughly
before operating this tool.



Technical Data.....	3
Power Requirements.....	3
 General Power Tool Safety Warnings.....	4
 Safety Warnings for Power Trimmers.....	5
Parts.....	6
Mounting.....	6
Start Up.....	8
Maintenance.....	9
Troubleshooting.....	9
Accessories and spare parts.....	10
Authorized Service Centers.....	11
Warranty Policy.....	12

CAUTION

To gain the best performance of the tool, prolong the duty life, make the Warranty valid if necessary, and to avoid hazards of fatal injuries please read and understand this Manual before using the tool.

Keep this manual for future references.

The illustrations in this manual are for reference only. They might be different from the real tool.

Use and care recommendations



In order not to damage the product, it is recommended to use a **16 AWG - HEAVY DUTY EXTENSION CORD** (not included).



ALWAYS USE the **GUARD. USE THREAD** with diameter from 0.080"



Perform periodic **MAINTENANCE** to your machine (page 9).

DES-1000

Code	•	13521
Description	•	Trimmer / Edger
Voltage	•	127 V~
Frequency	•	60 Hz
Current	•	8 A
Power	•	1.3 Hp
Speed	•	7 500 RPM
Cutting Capacity	•	14"
Cutting String Diameter	•	0.080"
Work Cycle	•	50 minutes' work per 20 minutes' rest. Maximum 6 hours daily.
Conductors	•	18 AWG x 2C with 221 °F insulation temperature.
Insulation	•	Class II
IP Grade	•	IP20

Power Cord Grips used is: Type "Y".
Tool Build Quality: Reinforced Insulation
Thermal insulation on motor winding: Class E

⚠ WARNING Avoid the risk of electric shock or severe injury. When the power cable gets damaged it should only be replaced by the manufacturer or at a TRUPER Authorized Service Center. The build quality of the electric insulation is altered if spills or liquid gets into the tool while in use. Do not expose to rain, liquids and/or dampness.

⚠ WARNING Before gaining access to the terminals all power sources should be disconnected.



Power Requirements

Before using a power cord or any other additional flexible cable verify it is not showing damage or abuse. DO NOT use the tool if the power cord is damaged or abused. If the cord gets damaged during use, disconnect it from the power supply immediately. DO NOT TOUCH THE POWER CORD BEFORE DISCONNECTING FROM THE POWER SUPPLY.

⚠ WARNING Tools with double insulation and reinforced insulation are equipped with a polarized plug (one prong is wider than the other). This plug will only fit in the right way into a polarized outlet. If the plug cannot be introduced into the outlet, reverse the plug. If it still doesn't fit, call a qualified electrician to install for you a polarized outlet. Do not alter the plug in any way. Both insulation types eliminates the need of both a grounded third power cord with three prongs or a grounded power connection.

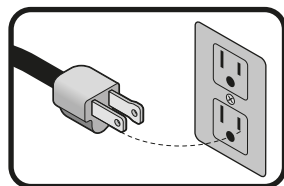

⚠ WARNING When using an extension cable, verify the gauge is enough for the power that your product needs. A lower gauge cable will cause voltage drop in the line, resulting in power loss and overheating. The following table shows the right size to use depending on cable's length and the ampere capability shown in the tool's nameplate. When in doubt use the next higher gauge.

Ampere Capacity	Number of Conductors	Extension Gauge	
		From 6 ft to 49 ft	Higher than 49 ft
From 0 A and up to 10 A	3 (one grounded)	18 AWG (*)	16 AWG
From 10 A and up to 13 A		16 AWG	14 AWG
From 13 A and up to 15 A		14 AWG	12 AWG
From 15 A and up to 20 A		8 AWG	6 AWG

* It is safe to use only if the extensions have a built-in artifact for over current protection.
AWG = American Wire Gauge - Reference NMX-J-195-ANCE

⚠ WARNING When operating power tools outdoors, use a **6 VOLTECK** grounded extension cable labeled "For Heavy Duty". These extensions are especially designed for operating outdoors and reduce the risk of electric shock.





⚠ WARNING! Read carefully all safety warnings and instructions listed below. Failure to comply with any of these warnings may result in electric shock, fire and / or severe damage. **Save all warnings and instructions for future references.**

Work area

Keep your work area clean, and well lit.

Cluttered and dark areas may cause accidents.



Never use the tool in explosive atmospheres, such as in the presence of flammable liquids, gases or dust.

Sparks generated by power tools may ignite the flammable material.



Keep children and bystanders at a safe distance while operating the tool.

Distractions may cause losing control.



Electrical Safety

The tool plug must match the power outlet. Never modify the plug in any way. Do not use any adapter plugs with grounded power tools.

Modified plugs and different power outlets increase the risk of electric shock.



Avoid body contact with grounded surfaces, such as pipes, radiators, electric ranges and refrigerators.

The risk of electric shock increases if your body is grounded.

Do not expose the tool to rain or wet conditions.

Water entering into the tool increases the risk of electric shock.

Do not force the cord. Never use the cord to carry, lift or unplug the tool. Keep the cord away from heat, oil, sharp edges or moving parts.

Damaged or entangled cords increase the risk of electric shock.

When operating a tool outdoors, use an extension cord suitable for outdoor use.

Using an adequate outdoor extension cord reduces the risk of electric shock.

If operating the tool in a damp location cannot be avoided, use a ground fault circuit interrupter (GFCI) protected supply.

Using a GFCI reduces the risk of electric shock.

Personal safety

Stay alert, watch what you are doing and use common sense when operating a tool. Do not use a power tool while you are tired or under the influence of drugs, alcohol or medication.

A moment of distraction while operating the tool may result in personal injury.

Use personal protective equipment. Always wear eye protection.

Protective equipment such as safety glasses, anti-dust mask, non-skid shoes, hard hats and hearing protection used in the right conditions significantly reduce personal injury.



Prevent unintentional starting up. Ensure the switch is in the "OFF" position before connecting into the power source and / or battery as well as when carrying the tool.

Transporting power tools with the finger on the switch or connecting power tools with the switch in the "ON" position may cause accidents.

Remove any wrench or vice before turning the power tool on.

Wrenches or vices left attached to rotating parts of the tool may result in personal injury.

Do not overreach. Keep proper footing and balance at all times.

This enables a better control on the tool during unexpected situations.

Dress properly. Do not wear loose clothing or jewelry. Keep hair, clothes and gloves away from the moving parts.

Loose clothes, jewelry, or long hair may get caught in moving parts.



If you have dust extraction and recollection devices connected onto the tool, inspect their connections and use them correctly.

Using these devices reduce dust-related risks.

Power Tools Use and Care

Do not force the tool. Use the adequate tool for your application.

The correct tool delivers a better and safer job at the rate for which it was designed.



Do not use the tool if the switch is not working properly.

Any power tool that cannot be turned ON or OFF is dangerous and should be repaired before operating.

Disconnect the tool from the power source and / or battery before making any adjustments, changing accessories or storing.

These measures reduce the risk of accidentally starting the tool.

Store tools out of the reach of children. Do not allow persons that are not familiar with the tool or its instructions to operate the tool.

Power tools are dangerous in the hands of untrained users.



Service the tool. Check the mobile parts are not misaligned or stuck. There should not be broken parts or other conditions that may affect its operation. Repair any damage before using the tool.

Most accidents are caused due to poor maintenance to the tools.



Keep the cutting accessories sharp and clean.

Cutting accessories in good working conditions are less likely to bind and are easier to control.

Use the tool, components and accessories in accordance with these instructions and the projected way to use it for the type of tool when in adequate working conditions.

Using the tool for applications different from those it was designed for, could result in a hazardous situation.

Service

Repair the tool in a TRUPER Authorized Service Center using only identical spare parts.

This will ensure that the safety of the power tool is maintained.

Children or people with reduced physical, sensory or mental capabilities shall not operate the tool, neither inexperienced people or without knowledge in the use of the tool, unless supervised by a person responsible of their safety or if receiving previous instructions about the tool operation.

Children shall be kept under supervision to double-check they will not play with the tool. Tight supervision shall be used with children or disabled persons to prevent from using or being close to any household tool.



Before operating the trimmer

⚠ CAUTION • It is recommended that the trimmer is connected by means of a Residual current device (RCD) with a cutting current no higher than 30 mA

- Read the instructions carefully. Familiarize yourself with the controls and the proper use of the equipment.
- Keep the additional flexible cord away from the cutting elements.
- Wear eye protection.
- Never allow children or people not familiarized with the equipment to use it.
- Do not use the equipment while there people around, especially children or pets.
- Use the equipment only in daylight or where there is good lighting.
- Never operate the machine with a damaged guard or protection, or without guards and protections in place
- Switch on the motor only when the hands and feet are away from the cutting elements.
- Never assemble metal cutting elements.
- Use only replacement parts and accessories recommended by the manufacturer.
- Always disconnect the device from the power supply when not in use.
- Disconnect the equipment from the power source before doing maintenance or cleaning.
- Inspect and provide regularly maintenance to the unit. The equipment must only be repaired in an authorized distribution center.
- Take care of not hurting with the knives used for adjusting the line length. After placing a new cutting line, put the tool back to its normal position before turning it on again.
- Make sure that the ventilation holes are free of waste.
- When not using the device, keep it away from the reach of the infants.

⚠ CAUTION • Carefully inspect the area to cut, to avoid any obstacle and remove any foreign object that could be thrown out by the trimmer. Otherwise, you could cause an accident and the useful life of the trimmer can be reduced.

⚠ CAUTION • The area to cut should be well illuminated.

⚠ CAUTION • Double-check every part in the trimmer is in excellent working condition and the cutting string is correctly set. Inspect the ventilation slots are free of debris. Refrain from using the trimmer if the guard is damaged or has missing parts.

⚠ WARNING • Use only the original nylon string and for no reason at all replace it with metal string.

- For best results it is recommended to use only original thread replacements such as: HTA-65B, HIDE-65P, HTA-65 and HDU-15-65 Truper® brand.
- Remember this tool is designed to cut grass as indicated in this Manual. For no reason at all it can be used for a different purpose.

⚠ WARNING • To prevent from electric shock refrain from working in humid environments, such as when is raining or there is dew on the grass.



- Before use check the power cord and extension cord for signs of damage or fraying. If the cord becomes damaged during use, disconnect the cord from the mains immediately. Do not touch the cord before switching off the power. Do not use the appliance if the cord is damaged or frayed.
- Wear protective eyewear and protective footwear at all times when operating the machine.
- Always disconnect the appliance from the power supply (i.e. remove the mains receptacle):
 1. Whenever the appliance is left unattended;
 2. When driving over an obstacle;
 3. Before inspecting, cleaning or working on the appliance;
 4. After striking a foreign object; and
 5. Whenever the appliance begins to vibrate abnormally.

While operating the trimmer

⚠ CAUTION • Do not operate the trimmer close to passersby, children or animals.

⚠ WARNING • Never set the cutting head above 11.8" of height and do not aim it towards people or animals.

⚠ WARNING • Use the trimmer only to cut at ground level. For no reason at all use it to cut vegetation on stones or walls.

⚠ CAUTION • Do not walk on gravel when the trimmer is running. The cutting string might shoot out gravel pieces towards the user or passersby causing injuries.

⚠ CAUTION • To prevent the cutting string damaging the cable always keep the trimmer's power cable visible.

⚠ WARNING • Refrain from putting your hands or feet close to the cutting head while the tool is running.

⚠ DANGER • In case of working close to transit roads stop cutting until there are no vehicles on sight. The trimmer could shoot debris towards the moving vehicles, thus causing a severe accident.

After operating the trimmer

⚠ ADVERTENCIA • Cutting elements continue to rotate after the engine is turned off.

- Do not try to stop the cutting string's rotating movement in any other way than releasing the switch. Wait until the spool comes to a complete stop after releasing the switch, this takes a few seconds.

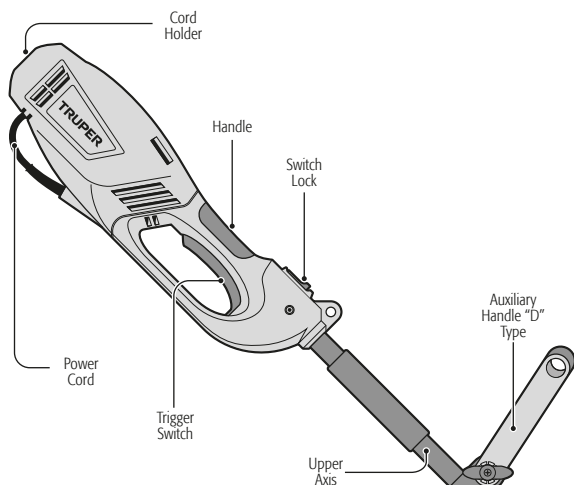

Safety alerts.



Read the Manual before operating the machine.



Wear hearing protection.



Wear safety eyeglasses.



Clear the area where the grass will be cut from objects which could get shot out. Keep people and animals away from the cutting area.



Keep away from children's reach.



In the event the power cable gets damaged disconnect the plug immediately.



Do not expose to humidity.

Mounting

Curved Axis

- Insert the curved axis (A) in the mount (B) matching the orifice (C) in the mount with the curved axis.
- Double check the curved axis' flexible shaft matches correctly inside the adapter (D) in the upper handle.
- Tighten the knob (E) to block the curved axis in place.

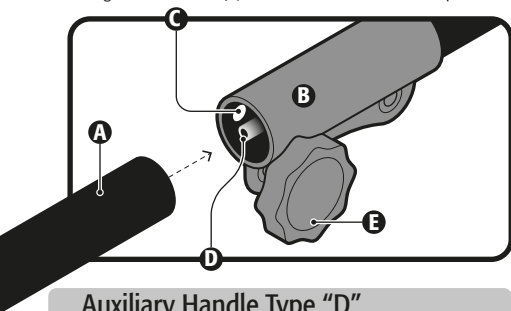

Auxiliary Handle Type "D"

- Install the auxiliary handle as shown in the image.
- Move the auxiliary handle by the upper axis into a height adequate to operate the trimmer.
- Tighten the knob to secure the position and angle in the auxiliary handle.

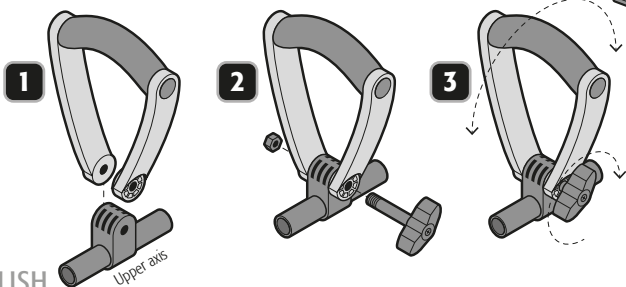

Guard

- Install the guard as shown in the image.
- Remember to correctly install the guard before turning ON the trimmer.

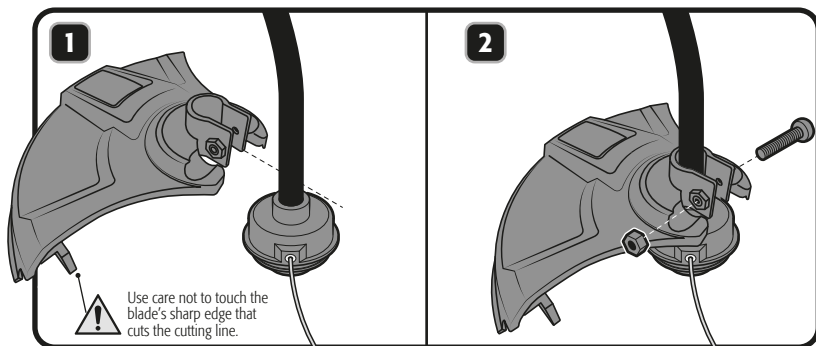

Cutting line spool

- Having the trimmer OFF and disconnected, remove the spool retention cap **(F)** turning in a counterclockwise direction.
- Remove the empty spool. Make sure is clean and there are no damaged or worn parts.
- Cut a 10 ft length of line.
- Bend the line to the middle of the length and insert in the notch.
- Hold both lines and thread in the direction indicated in the arrow on the spool. Double check each length of line is threaded in the respective section. (upper and lower). Do not thread too much line. After threading, there must be a 0.24" minimum distance between the spool edge and the threaded line.
- Leave unthreaded 6" approximately of both lengths of line and insert the upper section line in one of the notches in the spool cover. Give half a turn more to the spool and insert the line in the lower section in the opposite notch of the spool cover.

This measure is to prevent the line to get unthreaded while installing the spool in the trimmer. Further on, the threads shall be released from the notches.

- Set back the spool in its cover **(H)** passing each line ends through the orifices in the cover. If the line is released or tangled in this step, thread it again in the spool and secure in its notches.
- Pull outwards and apply force to both ends of the cutting line to release it from the notches in the upper side of the spool.
- Set the spool with its cover into the impulsion axis **(I)** and push the spool towards the axis to make the threaded edge stick out. Secure it with the retention cap **(F)**.
- When setting a new spool, release the tips of the lines from the notches and unthread 6" approximately of both lines to secure them back in their notches before setting the spool into the cover.
- We recommend using 0.080" diameter, model HDU-15-80, HLB-80, HTA-80, HTA-80B, HIDE-80P cutting lines.

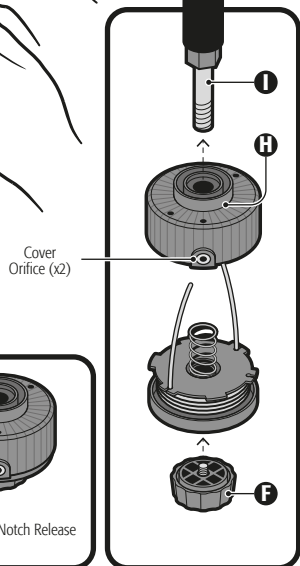
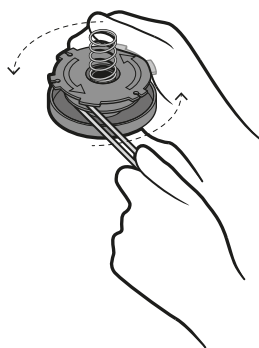
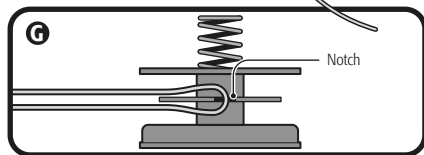

Turning ON

- Make a loop (A) in the end of a **SVOLTECK** brand grounded extension cable labeled "Heavy Duty" and secure through the fastener as shown in image (B).
- Connect the trimmer to the extension cable as shown in the figure.
- Stretch perfectly the extension cable to prevent obstacles.
- Connect the extension cable to a power outlet with the voltage specified for the trimmer.
- As an additional safety measure, use a current break (not included) if there are voltage peaks of 30 mA or less.
- To turn ON the trimmer press the switch lock (C) together with the switch (D). The switch lock prevents accidental startups.
- To turn it OFF, release the switch.

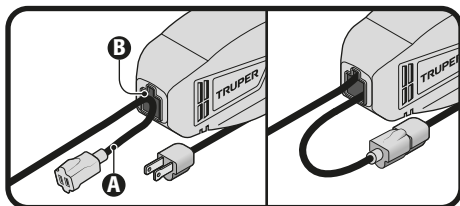

Operation

- CAUTION** • Remember that you as the trimmer operator are responsible of your own safety as well as those close to the work area. Follow all safety standards (pages 4 and 5) before operating the tool.
- Keep good footing with both feet firmly set onto the ground.

Hold the trimmer firmly in front of you. One hand shall be positioned on the handle and the other, onto the auxiliary handle so that the tool is aligned to your body and pointing the cutting head 30° towards the ground and away from your feet.

- DANGER** • Do not start or operate the trimmer in any other position.

- Turn ON the trimmer and carry out cuts from left to right and rotating the waist keeping the tool position.
- As the grass is trimmed, the cutting line wears out and will finally be detached. To release more line out from the spool, press the trimmer a little downwards so that the ground presses the retention cap against the spool and will release more line. The remaining line will be cut with the guard blade. In that instant stop pushing the trimmer against the ground to not waste line.
- To cut weeds or high grasses cut gradually. Do not try to cut in one pass from its base. Residues may clog the cutting head to make the user lose control on the trimmer.

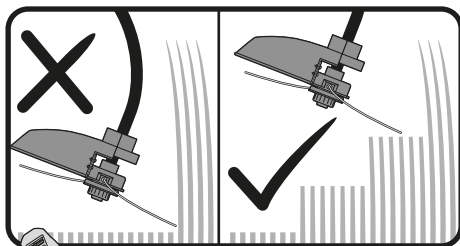
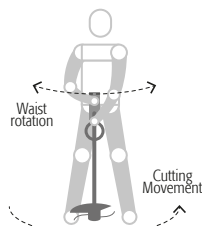
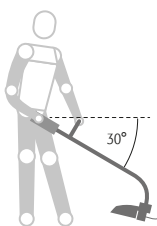
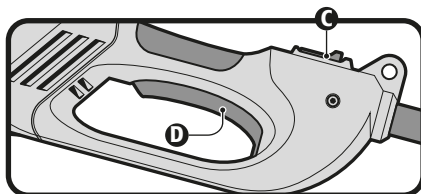

Edger

- It is possible to use the trimmer to cut and define the grass border following the edge of sidewalks and paths.
- Loosen the knob (E). Tighten the button opposite to the knob and release the curved axis.
- Turn the curved axis 180° to make the cutting line point downwards (F).
- Insert again the curved axis until the button clicks. Tighten the knob. The trimmer is ready to be used as edger.

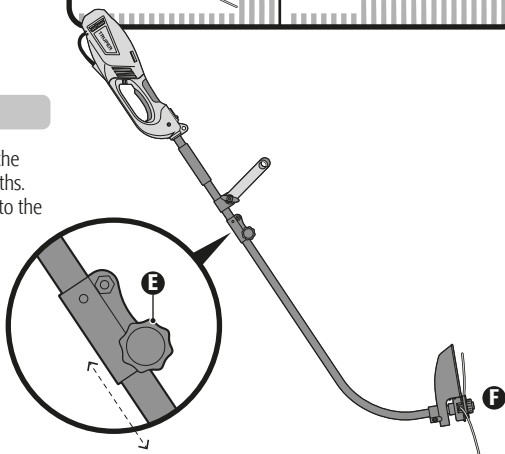

Cleaning

- Clean the trimmer after each use. It will keep in optimum conditions and will lengthen its useful life.
- To clean, use a cloth dampened with hot water and a soft brush.
- After each use disassemble all the tool parts and remove all the grass particles and dirt adhered. Use special care with the line spool and the notches, as well as the guards.
- Clean perfectly the trimmer ventilation slots to remove any grass or dirt obstruction.

Storing

- Clean the tool before storing to prevent mildew.
- Store the trimmer in a dry and temperate place, away from sun light (preferably in a dark place and away from the reach of children).
- Avoid storing the trimmer into a plastic bag. Otherwise, humidity generate can damage it.
- Do not store the trimmer with the guard supported onto the floor. It loses its shape. The trimmer shall be stored hanging from the upper handle so that the guard is not touching the floor.

Carbon Brush Replacement

- Carbon bushes shall be checked periodically. Always replace the carbon brushes in a TRUPER Authorized Service Center when worn. After replacement, ask the technician to inspect if the new carbon brushes can move freely in the carbon holder. Ask them to turn ON the machine during 5 minutes to make even the contact of the carbon brushes and the commutator.
- Use only original TRUPER spare carbon brushes designed specifically with the hardness and electric resistance adequate for each type of motor. Carbon brushes that are out of specification may damage the motor. When changing the carbon bushes, always replace both.

Environmental Protections

- The discarded tool materials like washers, damaged parts or the tool, after finishing its useful life shall not be handled like trash. Take the parts to a recycling center to be treated adequately according to the environment standards.

Troubleshooting

Problem

Cause

Solution

The cutting line does not advance when pressing the retention cap.

- The line adhere itself.
- There is not enough line in the spool.
- The line is tangled in the spool.
- The line is not released from the spool notches.

- Lubricate the cutting head with TRUPER silicon lubricant spray
- Set new line in the spool (consult page 7).
- Turn OFF the trimmer and thread again the line in the spool (consult page 7).
- Turn OFF the trimmer and pull the ends in both cutting lines to release them.

It is difficult the retention cap.





- The thread in the ring is dirty or damaged.

- Clean the threads and lubricate with grease. If the situation is not solved replace the retention cap.

Grass tangles around the lower axis and the cutting head.

- You are cutting too high with regards to the ground level.

- Cut the high grass in a gradual manner as explained in page 8.

Replacement	Code	Model	Description
	18439	RET-DES-1000	Spool retainer
	18438	TAP-DES-1000	Trimmer spool head replacement
	18437	REP-DES-1000	Trimmer spool / line replacement
	18436	CB-DES-1000	Carbon brushes replacement

In the event of any problem contacting a TRUPER Authorized Service Center, please see our webpage WWW.TRUPER.COM to get an updated list, or call our toll-free numbers 800 690-6990 or 800 018-7873 to get information about the nearest Service Center.

AGUASCALIENTES **DE TODO PARA LA CONSTRUCCIÓN**
GRAL. BARRAGÁN #1201, COL. GREMIAL, C.P. 20030, AGUASCALIENTES, AGS. TEL.: 449 994 0537

BAJA CALIFORNIA **SUCURSAL TIJUANA**
AV. LA ENCANTADA, LOTE #5, PARQUE INDUSTRIAL EL FLORIDO II, C.P. 22244, TIJUANA, B.C. TEL.: 664 969 5100

BAJA CALIFORNIA SUR **FIX FERRETERÍAS**
FELIPE ÁNGELES ESQ. RUIZ CORTÍNEZ S/N, COL. PUEBLO NUEVO, C.P. 23670, CD. CONSTITUCIÓN, B.C.S. TEL.: 613 132 1115

CAMPECHE **TORNILLERÍA Y FERRETERÍA AAA**
AV. ÁLVARO OBREGÓN #324, COL. ESPERANZA C.P. 24080 CAMPECHE, CAMP. TEL.: 981 815 2808

CHIAPAS **FIX FERRETERÍAS**
AV. CENTRAL SUR #27, COL. CENTRO, C.P. 30700, TAPACHULA, CHIS. TEL.: 962 118 4083

CHIHUAHUA **SUCURSAL CHIHUAHUA**
AV. SILVESTRE TERRAZAS #128-11, PARQUE INDUSTRIAL BAFAR, CARRETERA MÉXICO CUAUHTÉMOC, C.P. 31415, CHIHUAHUA, CHIH. TEL. 614 434 0052

CIUDAD DE MÉXICO **FIX FERRETERÍAS**
EL MONSTRUO DE CORREGIDORA, CORREGIDORA # 35, COL. CENTRO, C.P. 06060, CUAUHTÉMOC, CDMX. TEL: 55 5522 5031 / 5522 4861

COAHUILA **SUCURSAL TORREÓN**
CALLE METAL MECÁNICA #280, PARQUE INDUSTRIAL ORIENTE, C.P. 27278, TORREÓN, COAH. TEL.: 871 209 6823

COLIMA **BOMBAS Y MOTORES BYMTESA DE MANZANILLO**
BLVD. MIGUEL DE LA MADRID #190, COL. 16 DE SEPTIEMBRE, C.P. 28239, MANZANILLO, COL. TEL.: 314 332 1986 / 332 8013

DURANGO **TORNILLOS ÁGUILA, S.A. DE C.V.**
MAZURIO #200, COL. LUIS ECHEVERRÍA, DURANGO, DGO. TEL.: 618 817 1946 / 618 818 2844

ESTADO DE MÉXICO **SUCURSAL CENTRO JILOTEPEC**
PARQUE INDUSTRIAL # 1, COL. PARQUE INDUSTRIAL JILOTEPEC, JILOTEPEC, EDO. DE MÉX. C.P. 54257 TEL: 761 782 9101 EXT. 5728 Y 5102

GUANAJUATO **CÍA. FERRETERA NUEVO MUNDO S.A. DE C.V.**
AV. MÉXICO - JAPÓN #225, CD. INDUSTRIAL, C.P. 38010, CELAYA, GTO. TEL.: 461 617 7578 / 79 / 80 / 88

GUERRERO **CENTRO DE SERVICIO ECLIPSE**
CALLE PRINCIPAL MZ.1 LT. 1, COL. SANTA FE, C.P. 39010, CHILPANCINGO, GRO. TEL.: 747 478 5793

HIDALGO **FERREPRECIOS S.A. DE C.V.**
LIBERTAD ORIENTE #304 LOCAL 30, INTERIOR DE PASAJE ROBLED, COL. CENTRO, C.P. 43600, TULANCINGO, HGO. TEL.: 775 753 6615 / 775 753 6616

JALISCO **SUCURSAL GUADALAJARA**
AV. ADOLFO B. HORN # 6800, COL: SANTA CRUZ DEL VALLE, C.P.: 45655, TLAJOMULCO DE ZUÑIGA, JAL. TEL.: 33 3606 5285 AL 90

MICHOACÁN **FIX FERRETERÍAS**
AV. PASEO DE LA REPÚBLICA #3140-A, COL. EX-HACIENDA DE LA HUERTA, C.P. 58050, MORELIA, MICH. TEL.: 443 334 6858

MORELOS **FIX FERRETERÍAS**
CAPITÁN ANZURES #95, ESQ. JOSÉ PERDIZ, COL. CENTRO, C.P. 62740, CUAUTLA, MOR. TEL.: 735 352 8931

NAYARIT **HERRAMIENTAS DE TEPEC**
MAZATLAN #117, COL. CENTRO, C.P. 63000, TEPEC, NAY. TEL.: 311 258 0540

NUEVO LEÓN **SUCURSAL MONTERREY**
CARRETERA LAREDO #300, 1B MONTERREY PARKS, COLONIA PUERTA DE ANÁHUAC, C.P. 66052, ESCOBEDO, NUEVO LEÓN, TEL.: 81 8352 8791 / 81 8352 8790

OAXACA **FIX FERRETERÍAS**
AV. 20 DE NOVIEMBRE #910, COL. CENTRO, C.P. 68300, TUXTEPEC, OAX. TEL.: 287 106 3092

PUEBLA **SUCURSAL PUEBLA**
AV. PERIFÉRICO #2-A, SAN LORENZO ALMECATLA, C.P. 72710, CUAUTLACINGO, PUE. TEL.: 222 282 8282 / 84 / 85 / 86

QUERÉTARO **ARU HERRAMIENTAS S.A. DE C.V.**
AV. PUERTO DE VERACRUZ #110, COL. RANCHO DE ENMEDIO, C.P. 76842, SAN JUAN DEL RÍO, QRO. TEL.: 427 268 4544

QUINTANA ROO **FIX FERRETERÍAS**
CARRETERA FEDERAL MZ. 46 LT. 3 LOCAL 2, COL. EJIDAL, C.P. 77710 PLAYA DEL CARMEN, Q.R. TEL.: 984 267 3140

SAN LUIS POTOSÍ **FIX FERRETERÍAS**
AV. UNIVERSIDAD #1850, COL. EL PASEO, C.P. 78320, SAN LUIS POTOSÍ, S.L.P. TEL.: 444 822 4341

SINALOA **SUCURSAL CULIACÁN**
AV. JESÚS KUMATE SUR #4301, COL. HACIENDA DE LA MORA, C.P. 80143, CULIACÁN, SIN. TEL.: 667 173 9139 / 173 8400

SONORA **FIX FERRETERÍAS**
CALLE 5 DE FEBRERO #517, SUR LT. 25 MZ. 10, COL. CENTRO, C.P. 85000, CD. OBREGÓN, SON. TEL.: 644 413 2392

TABASCO **SUCURSAL VILLAHERMOSA**
CALLE HELIO LOTES 1, 2 Y 3 MZ. #1, COL. INDUSTRIAL, 2A ETAPA, C.P. 86010, VILLAHERMOSA, TAB. TEL.: 993 353 7244

TAMAULIPAS **VM ORINGS Y REFACCIONES**
CALLE ROSITA #527 ENTRE 20 DE NOVIEMBRE Y GRAL. RODRÍGUEZ, FRACC. REYNOSA, C.P. 88780, REYNOSA, TAMS. TEL.: 899 926 7552

TLAXCALA **SERVICIOS Y HERRAMIENTAS INDUSTRIALES**
PABLO SIDAR #132, COL. BARRIO DE SAN BARTOLOMÉ, C.P. 90970, SAN PABLO DEL MONTE, TLAX. TEL.: 222 271 7502

VERACRUZ **LA CASA DISTRIBUIDORA TRUPER**
BLVD. PRIMAVERA, ESQ. HORTENSIA S/N, COL. PRIMAVERA C.P. 93308, POZA RICA, VER. TEL.: 782 823 8100 / 826 8484

YUCATÁN **SUCURSAL MÉRIDA**
CALLE 33 #600 Y 602, LOCALIDAD ITZINCAB Y MULSAY, MPIO. UMAN, C.P. 97390, MÉRIDA, YUC. TEL.: 999 912 2451

Code	Model	Brand
13521	DES-1000	TRUPER®

Warranty. Duration: 2 years. Coverage: Parts, components, and labor are covered against manufacturing or operational defects, except when used under conditions other than normal, operated contrary to instructions, altered, or repaired by personnel not authorized by TRUPER. To activate the warranty, please present the product along with the sealed warranty, invoice, or receipt at the store where it was purchased. Alternatively, you can visit our location at Corregidora 35, Centro, Cuauhtémoc, CDMX, 06060. At this location, you can also acquire parts, components, consumables, and accessories. The warranty includes transportation expenses resulting from service compliance within our service network. For inquiries or assistance, please contact us at Tel. 800-018-7873. This product is made in/Hecho en China. Imported by TRUPER, S.A. de C.V., Industrial Park 1, Industrial Park Jilotepec, Jilotepec, State of Mexico, C.P. 54257, Tel. 761 782 9100.

Stamp of the business. Delivery date:

